



The HEC range of coolers is the ideal solution for all manufacturing needs in the field of rigid or plasticized PVC DRY-BLEND. Available with standard capacities of up to 8.500 liters. The development and optimization of the coolers of mixing plant is the latest PLAS MEC innovation, today it is a straightforward task to cool over 8 batches per hour of U-PVC from 120°C to 40°C.

The new water circuit design increases cooling efficiency enabling a significant increase in the productivity of the cooler and, therefore, the mixing plant. The new cooling interspace can withstand a working pressure of 2.5 bar, a typical pressure of factory closed circuit chillers. This, in addition to increasing the efficiency of heat exchange, solves many critical issues typical of closed circuit chillers.

The HEC cooler stands out for its great and proven cooling efficiency, allowing excellent throughput and high standards of quality. Material can be stored at lower temperature because it is cooled not only superficially but also at the core and thus has no thermal inertia that will cause packing.

Cleaning and maintenance times are reduced to a minimum thanks to total opening of the lid, which allows easy access to all internal parts. Applicable to any type of turbomixer and can be built in special versions and/or with larger capacities to meet specific customer needs.

### FEATURES

#### HORIZONTAL COOLING VESSEL

- Built entirely of stainless steel as regards the parts in contact with the material, features a double or triple jacket for circulation of cooling water.

#### MIXING TOOL

- Made of stainless steel
- with axial and radial mixing effect, designed to optimize distribution of the hot material on the cooling surfaces.

#### TEMPERATURE CONTROL

- By means of thermocouple located at the side on the lateral wall of the cooling vessel.

#### LID

- Opens along the entire length of the cooling unit, equipped with double jacket for water circulation. Intrinsic safety opening system with lead screw type mechanic or automatic actuator.
- Safety device only allowing the lid to be opened after the mixer has stopped moving.
- Safety limit switch that shuts down the motor on opening.

Type	Total capacity Lt.	Motor power kW	
		Standard	Boost
HEC 800	800	5.5	7.5
HEC 1000	1000	7.5	11
HEC 1500	1500	11	15
HEC 1800	1800	18.5	22
HEC 2500	2500	22	30
HEC 3500	3500	30	37
HEC 4500	4500	45	55
HEC 5500	5500	55	65
HEC 6500	6500	75	90
HEC 8500	8500	75	90

NOTE: The data in the table are given merely by way of example and will have to be confirmed by PLAS MEC.

## PLUG OR SEMI-SPHERICAL DISCHARGE OUTLET

Closure plug suited the internal shape of the vessel, to be used according to the type of production and/or formulation.



## ADDITIONAL INLETS FOR MATERIAL

Dual batch technology, loading regrind, etc.



## SAMPLING VALVE

Allows mix quality control.



## DOUBLE DISCHARGE OUTLET

Discharge of material to a second user.

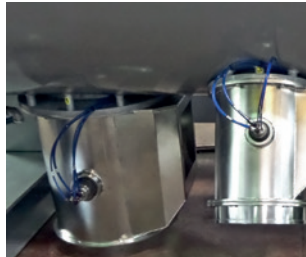

## HEAT EXCHANGER FOR COOLING WATER CIRCULATION

Keeps the water supply circuit separate from the cooler jacket, preventing material/calcium carbonate/dirt from depositing inside the jacket.

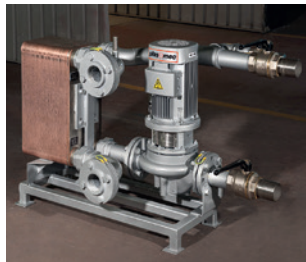

## FILTER SYSTEM

Self-cleaning filters for powder suction.



## CHOPPER

Elimination and reduction of any lumps in the mix.

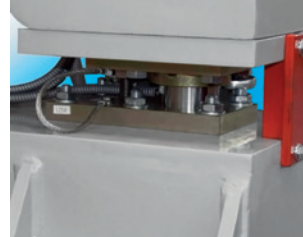

## INSTALLATION ON LOAD CELLS

Used to determine the amount of material in the cooler.



## AUTOMATIC LID OPEN

Allows a more comfortable and safety opening of the lid and avoid physical efforts.

Dimensions	A	B	C
HEC 800	2400	1220	950
HEC 1000	2685	1400	950
HEC 1500	2895	1550	1100
HEC 1800	3270	1650	1200
HEC 2500	3480	2050	1300
HEC 3500	3750	2100	1400
HEC 4500	4150	2250	1625
HEC 5500	4600	2250	1625
HEC 6500	4800	2250	1800
HEC 8500	6000	2250	1800

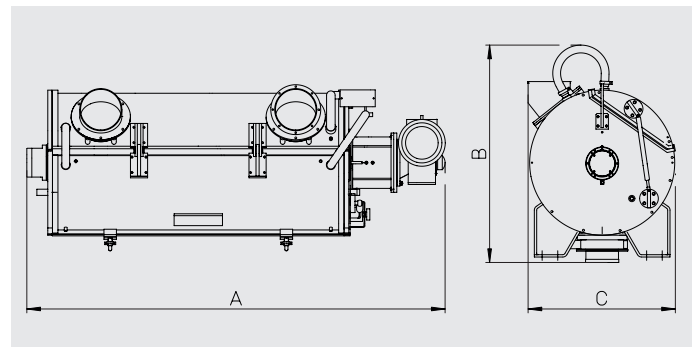

PVC DRY BLEND, POWDER COATINGS, MASTERBATCH AND PIGMENTS, THERMOPLASTIC RUBBERS, WOOD PLASTIC COMPOSITES AND MORE...

**PLAS MEC S.R.L.** Mixing Systems for Plastics and Powder Coatings

Via Europa, 79 - 21015 Lonate Pozzolo (VA) - ITALY - Tel. +39 0331 301648 (r.a.) - Fax +39 0331 301749 - mail: comm@plasmec.it - [www.plasmec.it](http://www.plasmec.it)



100% MADE IN  
**PLAS MEC**