

The large capacity of the cooling vessel and its special design shape, allow homogenization and cooling of three or more simultaneous mixers from the turbomixer.

Production models available up to 5.500 liters capacity and can be connected to every type of turbomixer and constructed in special versions and/or with larger capacities according to the customer's specific requirements.

Final temperatures of around 50°/60°, lower temperatures are possible through reduction of the turbomixer's hourly production rate.

### FEATURES

#### VESSEL

- Internal parts in contact with the material are in stainless steel
- Double jacket for circulation of cooling water

#### MIXING TOOL

- Made of stainless steel, with axial and radial mixing effect, designed to optimize distribution of the material on the cooling surfaces.

#### TEMPERATURE CONTROL

- By means of thermocouple located at the side of the mixing vessel to control operating and safety temperatures.

#### LID

- Hinged for inspection
- Polished internally for cleanliness
- Safety limit-switch with motor cut-off on opening

#### DISCHARGE

- With pneumatically-operated butterfly valve

Type	Total capacity Lt.	Motor power kW	
		Standard	Boost
RFO 500	500	4	7,5
RFO 1000	1000	7,5	11
RFO 1200	1200	11	15
RFO 1500	1500	11	15
RFO 2000	2000	15	18
RFO 2500	2500	18	22
RFO 3000	3000	22	30
RFO 4500	4500	37	45
RFO 5500	5500	55	70

NOTE: the data in the table are given merely by way of example and will have to be confirmed by PLAS MEC.

## PLUG OR SEMI-SPHERICAL DISCHARGE OUTLET

Closure plug suited the internal shape of the vessel, to be used according to the type of production and/or formulation.



## ADDITIONAL INLETS FOR MATERIAL

Dual batch technology, loading regrind, etc.



## SAMPLING VALVE

Allows mix quality control



## DOUBLE DISCHARGE OUTLET

Discharge of material to a second user.



## FILTER SYSTEM

Self-cleaning filters for powder suction.



## CHOPPER

Elimination and reduction of any lumps in the mix.



## INSTALLATION ON LOAD CELLS

Used to determine the amount of material in the cooler.

Dimensions	A	B	C
RFO 500	885	2200	1015
RFO 1000	1010	2560	1300
RFO 1200	1010	2850	1300
RFO 1500	1250	2850	1420
RFO 2000	1250	3200	1650
RFO 2500	1455	3450	1700
RFO 3000	1455	3760	1770
RFO 4500	1560	4270	1900

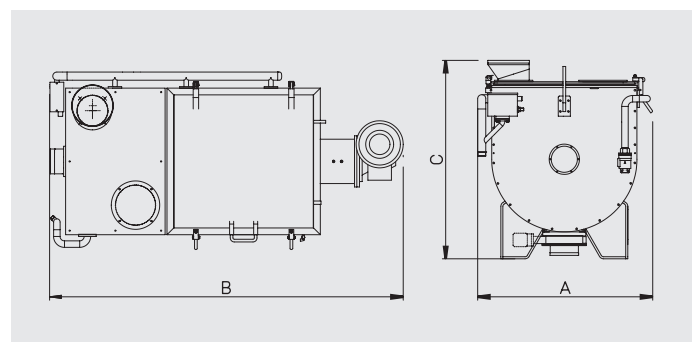

PVC DRY BLEND, POWDER COATINGS, MASTERBATCH AND PIGMENTS, THERMOPLASTIC RUBBERS, WOOD PLASTIC COMPOSITES AND MORE...

**PLAS MEC S.R.L.** Mixing Technologies

Via Europa, 79 - 21015 Lonate Pozzolo (VA) - Italy - Tel. +39 0331 301648 (r.a.) - Fax +39 0331 301749 - mail: comm@plasmec.it - [www.plasmec.it](http://www.plasmec.it)

